

PANEL SCREW RETAINER TYPE C

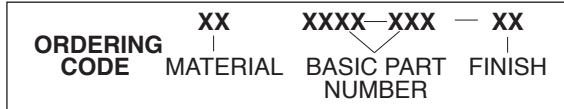
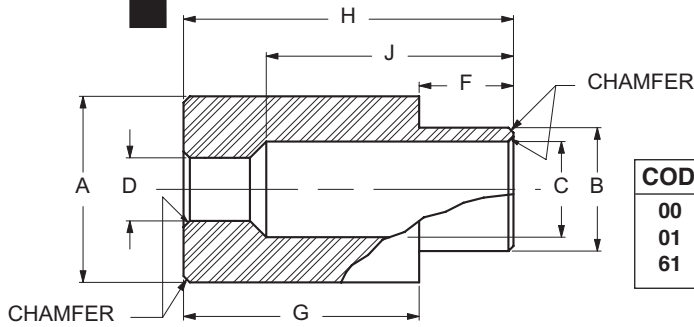

CODE	FINISH
00	Plain — None
01	Passivate ASTM A967-05
61	Nickel QQ-N-290 CL 1, Type VI KC

MATERIAL	CODE
BRASS	BR
STAINLESS STEEL	SS
STEEL	ST

NOTE: Retainer Ring and Retainer Spring NOT included: See Page E36

BASIC PART NUMBER	THREAD	PANEL THICKNESS	A ±0.004	B +0.000 -0.003	C +0.004 -0.001	D +0.004 -0.001	F ±0.005	G ±0.005	H ±0.010	J ±0.005
R017-062	4-40	.052-.067	9/32	.250	.210	.125	.062	.312	3/8	.299
R017-093	4-40	.084-.099	9/32	.250	.210	.125	.093	.281	3/8	.299
R017-125	4-40	.109-.140	9/32	.250	.210	.125	.125	.250	3/8	.299
R017-187	4-40	.171-.203	9/32	.250	.210	.125	.187	.187	3/8	.299
R018-062	6-32	.052-.067	9/32	.250	.210	.152	.062	.312	3/8	.304
R018-093	6-32	.084-.099	9/32	.250	.210	.152	.093	.281	3/8	.304
R018-125	6-32	.109-.140	9/32	.250	.210	.152	.125	.250	3/8	.304
R018-187	6-32	.171-.203	9/32	.250	.210	.152	.187	.187	3/8	.304
R019-062	8-32	.052-.067	17/32	.433	.386	.177	.062	.500	9/16	.447
R019-093	8-32	.084-.099	17/32	.433	.386	.177	.093	.468	9/16	.447
R019-125	8-32	.109-.140	17/32	.433	.386	.177	.125	.437	9/16	.447
R019-187	8-32	.171-.203	17/32	.433	.386	.177	.187	.375	9/16	.447
R019-250	8-32	.234-.265	17/32	.433	.386	.177	.250	.312	9/16	.447
R020-062	10-24	.052-.067	17/32	.433	.386	.203	.062	.500	9/16	.464
R020-093	10-24	.084-.099	17/32	.433	.386	.203	.093	.468	9/16	.464
R020-125	10-24	.109-.140	17/32	.433	.386	.203	.125	.437	9/16	.464
R020-187	10-24	.171-.203	17/32	.433	.386	.203	.187	.375	9/16	.464
R020-250	10-24	.234-.265	17/32	.433	.386	.203	.250	.312	9/16	.464
R021-062	10-32	.052-.067	17/32	.433	.386	.203	.062	.500	9/16	.464
R021-093	10-32	.084-.099	17/32	.433	.386	.203	.093	.468	9/16	.464
R021-125	10-32	.109-.140	17/32	.433	.386	.203	.125	.437	9/16	.464
R021-187	10-32	.171-.203	17/32	.433	.386	.203	.187	.375	9/16	.464
R021-250	10-32	.234-.265	17/32	.433	.386	.203	.250	.312	9/16	.464
R022-062	12-24	.052-.067	17/32	.433	.386	.228	.062	.500	9/16	.459
R022-093	12-24	.084-.099	17/32	.433	.386	.228	.093	.468	9/16	.459
R022-125	12-24	.109-.140	17/32	.433	.386	.228	.125	.437	9/16	.459
R022-187	12-24	.171-.203	17/32	.433	.386	.228	.187	.375	9/16	.459
R022-250	12-24	.234-.265	17/32	.433	.386	.228	.250	.312	9/16	.459
R023-062	1/4-20	.052-.067	17/32	.433	.386	.257	.062	.500	9/16	.475
R023-093	1/4-20	.084-.099	17/32	.433	.386	.257	.093	.468	9/16	.475
R023-125	1/4-20	.109-.140	17/32	.433	.386	.257	.125	.437	9/16	.475
R023-187	1/4-20	.171-.203	17/32	.433	.386	.257	.187	.375	9/16	.475
R023-250	1/4-20	.234-.265	17/32	.433	.386	.257	.250	.312	9/16	.475
R024-062	1/4-28	.052-.067	17/32	.433	.386	.257	.062	.500	9/16	.475
R024-093	1/4-28	.084-.099	17/32	.433	.386	.257	.093	.468	9/16	.475
R024-125	1/4-28	.109-.140	17/32	.433	.386	.257	.125	.437	9/16	.475
R024-187	1/4-28	.171-.203	17/32	.433	.386	.257	.187	.375	9/16	.475
R024-250	1/4-28	.234-.265	17/32	.433	.386	.257	.250	.312	9/16	.475

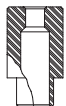

E31